



****AVAILABLE MAY 2026** **FURNISHED****
****PRIVATE GARDENS**** A rare opportunity to rent this two bedroom ground floor garden apartment, perfectly placed on the south-west backing side of Akenside Terrace, Jesmond. Located within the heart of South Jesmond Conservation Area, Jesmond and also within walking distance to Newcastle City Centre. Akenside Terrace is perfectly placed close to Jesmond Metro Station, Clayton Road and also the café culture of Jesmond.



Boasting almost 1,100 Sq ft, with period features and tall ceilings, the accommodation briefly comprises: private entrance door; hallway; 23ft lounge/diner with feature fireplace, ornate cornice, spot lighting and French doors leading out to the rear garden; kitchen with a range of fitted units, work surfaces, dual aspect windows, open to utility room with side door access out to the rear garden; bedroom one measuring 20ft with walk in bay, fitted alcove wardrobe storage, ornate cornice and decorative ceiling rose; bedroom two; bathroom complete with three piece suite. Externally, a mature front garden with planting and a pathway leading to the front door. To the rear, an enclosed south-west facing garden with mature planting, a paved patio seating area and a mixture of hedge and tree boundaries. Available on a furnished basis, this fantastic property would be great for professionals and is not to be missed!

Available 11th May 2026 | £1,250pcm | Ground Floor Garden Apartment | 1,094 Sq ft (101.6m²) | Two Double Bedrooms | 23ft Lounge/Diner | Kitchen | Utility Room | Bathroom WC | Private Front & Rear Gardens | Tall Ceilings & Period Features | Great Location | Furnished | On Street Parking | Council Tax Band: C | EPC Rating: D

£1,250 PCM

IMPORTANT NOTE: These particulars and the descriptions and measurements herein do not constitute representation and whilst every effort has been made to ensure accuracy, this cannot be guaranteed.

GROUND FLOOR
1094 sq.ft. (101.6 sq.m.) approx.

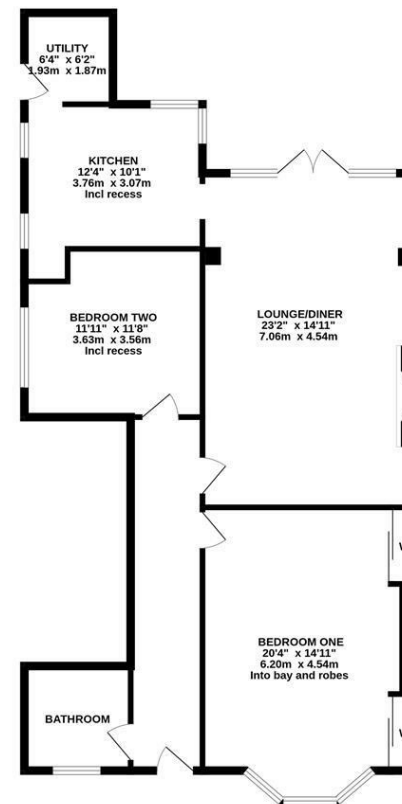

TOTAL FLOOR AREA: 1094 sq.ft. (101.6 sq.m.) approx.

Whilst every attempt has been made to ensure the accuracy of the floorplan contained here, measurements of doors, windows, rooms and any other items are approximate and no responsibility is taken for any error, omission or mis-statement. This plan is for illustrative purposes only and should be used as such by any prospective purchaser. The services, systems and appliances shown have not been tested and no guarantee as to their operability or efficiency can be given.
Made with Metropix ©2023

